

Technical specifications

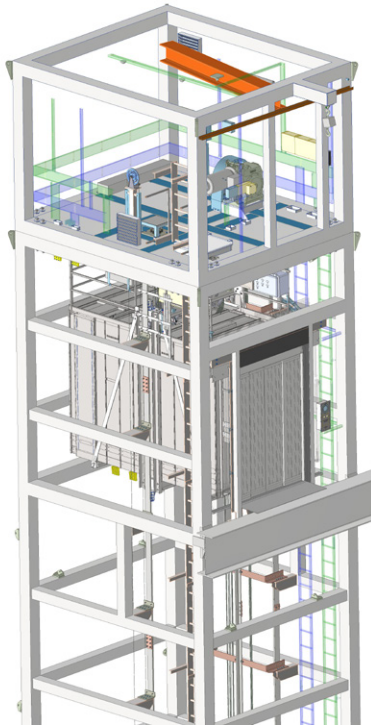

MAIN CHARACTERISTICS

- Wide range of car sizes and capacities
- Machine room as standard with Machine Room Less (MRL) solutions available
- Ingress protection rating up to IP65
- Surface treatment: corrosion classification up to C5 / HDG
- Detailed technical installation and operation manuals
- Elevator with Machine Room Less (MRL) also available for hazardous areas (Exc. Zone 2) in accordance to ATEX Directive

	ALIMAK WE	ALIMAK WE-Ex
Payload capacity	300 kg - 12,000 kg	300 kg - 10,000 kg
Travelling speed	0.3 - 1.6 m/s*	0.3 - 0.5 m/s
Lifting height, max.	60 m**	60 m**
Car width, internal	0.8 m - 2.8 m	0.8 m - 2.8 m
Car length, internal	0.8 m - 6.0 m	0.8 m - 6.0 m
Car height, internal	2.0 m - 3.5 m	2.0 m - 3.5 m
Door opening height	2.0 m - 3.5 m	2.0 m - 3.5 m
No. of landings	2 - 20	2- 20
Control system	Selective collective	Selective collective***
Motor control	Frequency Control (FC)	Frequency Control (FC)
Power supply range	360-690 V, 50-60 Hz, 3 phase	360-690 V, 50-60 Hz, 3 phase
Regulations	Lift Directive 2014/33 (EN 81)	Lift Directive 2014/33 and ATEX Directive

* Max. speed on cars with capacity 2,500 kg and above is 1.0 m/s

** Increased travel height on request

*** Located in SAFE AREA

CAR DOOR CONFIGURATIONS (A, B OR A + B)

